

Africa



&BEYOND

PHINDA ZUKA LODGE

Phinda Private Game Reserve



SOUTH AFRICA

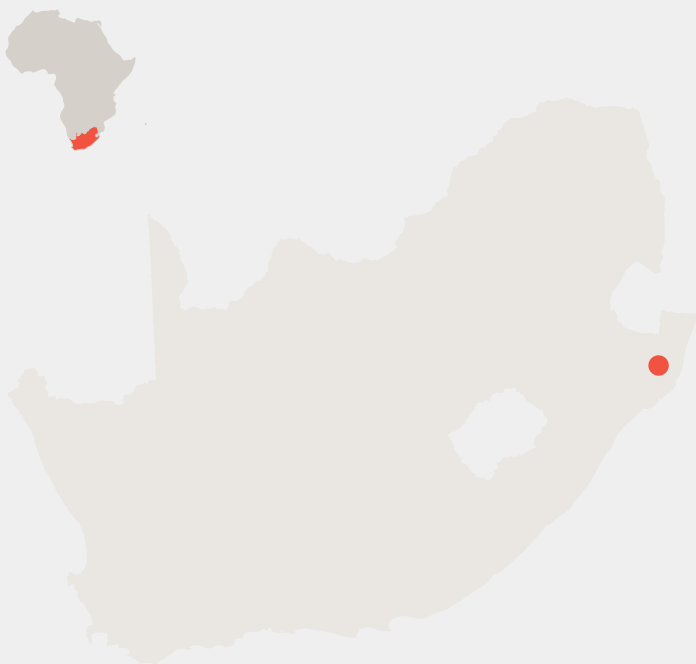

&Beyond Phinda Private Game Reserve encompasses an impressive 28 555 hectares (70 560 acres) of protected wildlife land in KwaZulu-Natal, South Africa. Showcasing one of the continent's finest game viewing experiences, &Beyond Phinda is home to Africa's Big Five (lion, leopard, elephant, buffalo and rhino), as well as 436 bird species. The reserve is particularly well known for close-up sightings of the elegant yet elusive cheetah, as well as the rare black rhino.

With its seven distinct habitats, Phinda is often described as 'Seven Worlds of Wonder', a magnificent tapestry of woodland, grassland, wetland and forest, interspersed with mountain ranges, rivers, marshes and pans. Home to 1 000 hectares of Africa's remaining rare dry sand forest, the reserve is situated in close proximity to the unspoiled beaches and spectacular coral reefs of the Indian Ocean, offering an unmatched combination of bush and beach adventures.

Guests at Phinda experience unforgettable interpretive game drives in open 4x4 safari vehicles, led by professionally trained &Beyond rangers and Zulu trackers, as well as a wide range of optional adventures in the bush and on the beach.

Phinda is home to six magnificent lodges, each with its own individual charm and character: Mountain Lodge, Rock Lodge, Forest Lodge, Vlei Lodge, Zuka Lodge and Phinda Homestead.

{Phinda Zuka Lodge}

www.andBeyond.com



Bordered by lush green valleys and densely wooded hills studded with aloes, **&Beyond** Phinda Zuka Lodge sits in the west of the reserve. With just four thatched Zululand bush suites, this intimate lodge is ideal for family gatherings and special occasion safaris and can be booked as a sole-use villa or for individual room bookings. Characterised by hues of blue and stone, with a strong emphasis on shape and texture, Zuka's overall ambiance is that of cool, coastal bush style embodying the sophistication of simplicity. The charming suites cluster around a busy waterhole where a diversity of wildlife is regularly seen and birdlife flourished. Each suite boasts a luxurious ensuite bathroom, complete with a circular bath chamber, double showers and twin hand basins. Comfortable lounge chairs on private verandas allow for gentle contemplation or even an afternoon siesta. Guest areas include an interactive café-style kitchen, indoor sitting and dining areas, an intimate library with internet access and a swimming pool with an extended wooden deck overlooking the surrounding wilderness.

AT A GLANCE

- 4 air-conditioned bush suites
- Can be booked as a sole-use safari villa or on a per-room basis
- Dedicated open 4x4 safari vehicle
- Personal ranger/host, tracker, butler and chef
- Interactive kitchen
- Swimming pool
- Library
- Boma for open-air dining

WHAT SETS US APART

- Ideal for sole-use by families and small groups
- Private watering hole can be seen from the pool and two of the suites
- Home away from home with the ultimate comforts
- Enjoy the opportunity to set your own game drive times and schedule for the day
- Seven habitats allow for much greater diversity in species and landscapes
- Wildlife includes cheetah, black rhino and nyala
- Variety of adventures available
- 28 555 hectares (70 560 acres) private game reserve with limited number of vehicles

ACTIVITIES

Included

- Twice-daily game drives, including afternoon / evening drives
- Bush walks

At an additional charge

- Phinda Adventures include Zulu village tours, Maputaland beach adventures, night turtle drives (seasonal), scuba safaris, an ocean safari and black rhino tracking on foot.
- Specialist Safaris include birding, photographic, rhino capture and research, tracking, luxury walking, family and private safaris

GUEST SAFETY

The lodge is not fenced off and we request guests be extremely vigilant at all times. Security guards accompany guests at all times when walking around the lodge at night.

ACCESS

- Airlink offer daily scheduled flights from Johannesburg to **&Beyond** Phinda Private Game Reserve. Connect **&Beyond** Phinda to Johannesburg, Cape Town, **&Beyond** Ngala Private Game Reserve, **&Beyond** Kirkman's Kamp, northern Sabi Sand Game Reserve, Vilanculos and Livingstone.
- Connect **&Beyond** Phinda Private Game Reserve to: Johannesburg, Cape Town, **&Beyond** Ngala Private Game Reserve, **&Beyond** Kirkman's Kamp, northern Sabi Sand Game Reserve, Londolozi, Ulusaba, Vilanculos and Livingstone. All flights route through either Nelspruit or Skukuza
- Seven-hour drive from Johannesburg on good roads in a two-wheel drive vehicle
- Three and a half-hour drive from Durban on good roads in a two-wheel drive vehicle
- Private charters from anywhere in South Africa can be arranged to **&Beyond** Phinda Private Game Reserve's airstrip

ACCOLADES



2015 - **&BEYOND'S** LODGES IN THE **&BEYOND** PHINDA PRIVATE GAME RESERVE ARE LISTED AMONG THE TOP 100 HOTELS & RESORTS IN THE WORLD AT THE CONDÉ NAST TRAVELER (US) READERS' CHOICE AWARDS AND FEATURED AMONG THE TOP 12 RESORTS IN SOUTH AFRICA



2015 - CONDÉ NAST TRAVELLER INDIA FEATURES **&BEYOND** PHINDA PRIVATE GAME RESERVE AS ONE OF SOUTH AFRICA'S SEXIEST WILDLIFE CAMPS



2014 - **&BEYOND** PHINDA PRIVATE GAME RESERVE IS # 10 IN CONDE NAST TRAVELER "BEST RESORTS IN SOUTH AFRICA" AFRICA & MIDDLE EAST CATEGORY

"Our trip to Phinda was amazing. The experience was something altogether different and much more than we could have imagined. Our driver and tracker were fantastic! They were knowledgeable, personable and also were conscious of letting us experience the sounds and animals without talking at certain moments. They took us to the most amazing sunset spot and I could not have imagined it getting any better. But it did. We came back to a seven-course dinner set up outside for us. I cannot say enough how happy we were with everyone at the lodge."

- Brett & Nicole
&Beyond guests



TABLE OF FACTS

NUMBER OF ROOMS	4
MAXIMUM GUESTS	8
CHILDREN	Yes; no children under 16 on Walking Safaris; children 5 years and younger cannot participate in game drives; children aged 6 to 11 permitted on game drives at the lodge manager's discretion
CHILDMINDING	Available at an additional cost
TRIPLES	One (only for children 16 years or younger and only when lodge is booked for sole use)
TWIN BEDS	All convertible to doubles
AIR CONDITIONING	Yes
OVERHEAD FANS	Yes
LODGE POOL	Yes
BATH	Yes
INDOOR SHOWERS	Yes
SEPARATE W.C.	Yes
IN-ROOM SAFE	Yes
PERSONAL BAR	No
TELEPHONE	Yes
HAIRDRYER	Yes
LAUNDRY INCLUDED	Yes
WHEELCHAIR ACCESS	Yes, with assistance
DISTANCE BETWEEN ROOMS	15m / 50ft
CHECK IN / CHECK OUT	14h00 / 11h00
KOSHER FOOD	Available with prior notice and at extra cost

POWER	220v AC
INTERNET ACCESS	Yes, in guest area and suites
PRIVATE 4X4 SAFARI VEHICLE	No
CREDIT CARDS	Visa, Diners, Amex, MasterCard
IN-ROOM MASSAGE	Yes
EXERCISE EQUIPMENT	Gym in a bag available on request
WEATHER	Subtropical climate with hot, humid and wet summers from September to April and warm to cool and dry winters from May to August
RAINFALL	Rainfall averages 1 000mm / 39" per annum. Much of the rainfall comes in the form of short, intense afternoon thundershowers. Rain can be expected throughout the year
TEMPERATURE	Summer: daytime temperatures above 35 °C / 95 °F Winter: night-time temperature rarely drops below 10 °C / 50 °F
BEST TIME TO TRAVEL	All year round; best game viewing from March to end of September
MALARIA	The reserve is situated in a low-risk malaria area
AIRSTRIP	The Phinda airstrip is not registered; coordinates are S27° .51.36' and E32° .18.48'
GPS COORDINATES	S27° 46.657' and E32° 20.942'
LODGE CLOSURE	Open year round

NOTE

- Please note that park fees and government charges may apply. Speak to your travel consultant for more details.
- Drones are not permitted at **&Beyond** reserves, lodges, camps and villas..

CAMP LAYOUT

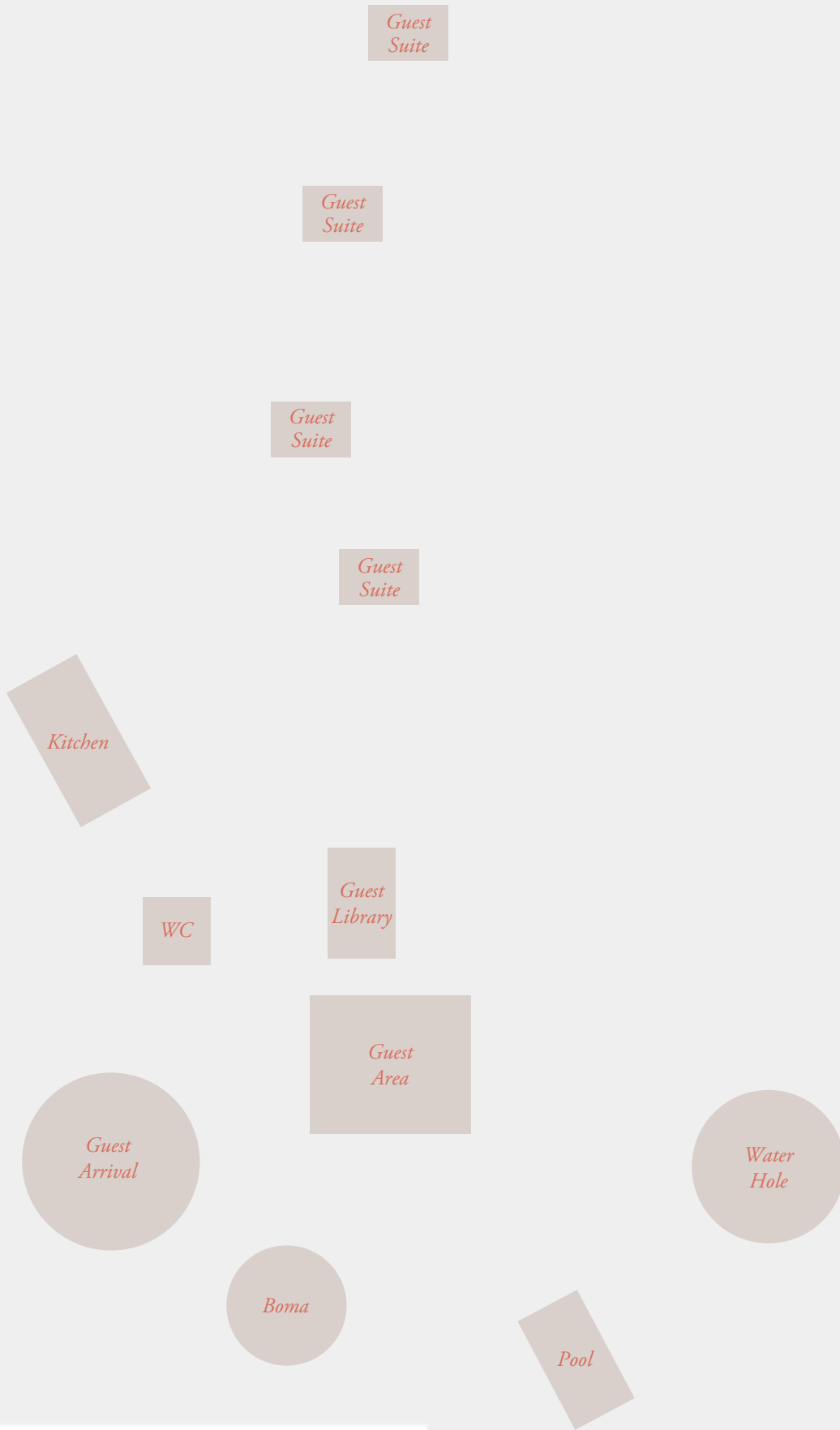

CONTACT